

Nostalgia

TOWNLET



RETAIL LEASING OPPORTUNITIES

LOCATION

► [View on Google Maps](#)

Nostalgia Townlet is located south of the vibrant communities of Mahogany, Auburn Bay and Seton, which boasts the world's largest YMCA, the South Health Campus and a public library.



1 South Health Campus



2 J.C.S. High School



3 YMCA at Seton



4 Seton Public Library



5 Seton Urban District



NOSTALGIA TOWNLET SITE PLAN



A Private mixed-use main street and network of walkable streets and public spaces.

B Nostalgia independent / private school and Jayman Journey Club Seniors Care Facility

C The Nostalgia Club

D Interconnected canal system with innovative townhomes and intimate public spaces.

E Future public school site and associated play fields.

F Future boutique retail, convention centre, hotel and network of riverfront pedestrian streets.

G Slope adaptive escarpment multi-residential housing

H Sales centre and future community association building

I Proposed feature chapel and innovative escarpment housing courts.

J Nautilus Pond: an innovative stormwater management system designed to improve water treatment.



DEVELOPMENT HIGHLIGHTS

Nostalgia Townlet will include approximately 60,000 sq. ft. of retail and professional services. **SITE 1** will include a specialty grocer market, a pub/restaurant and retail units ranging from approximately 900 sq. ft. to 5,400 sq. ft.

RESIDENTIAL DEVELOPED AT FULL BUILD-OUT

Low-Density Units 2,399

Multi-Family Units 3,248

TARGET USES FOR SITE 1 INCLUDE:

- Market Neighbourhood/Specialty Grocer, Bakery, Butcher, etc.
- Coffee Shop and Quick Service Restaurant
- Salon, Barber and Personal Services
- Pet Supplies
- Medical and Dental
- Pharmacy
- Professional Services
- Fashion and Jewelry
- Boutique Wine & Spirits
- Fitness and Wellness



IN PARTNERSHIP
WITH



Architectural renderings, for marketing purposes only. Subject to change.

SITE MAP - MAIN STREET RETAIL

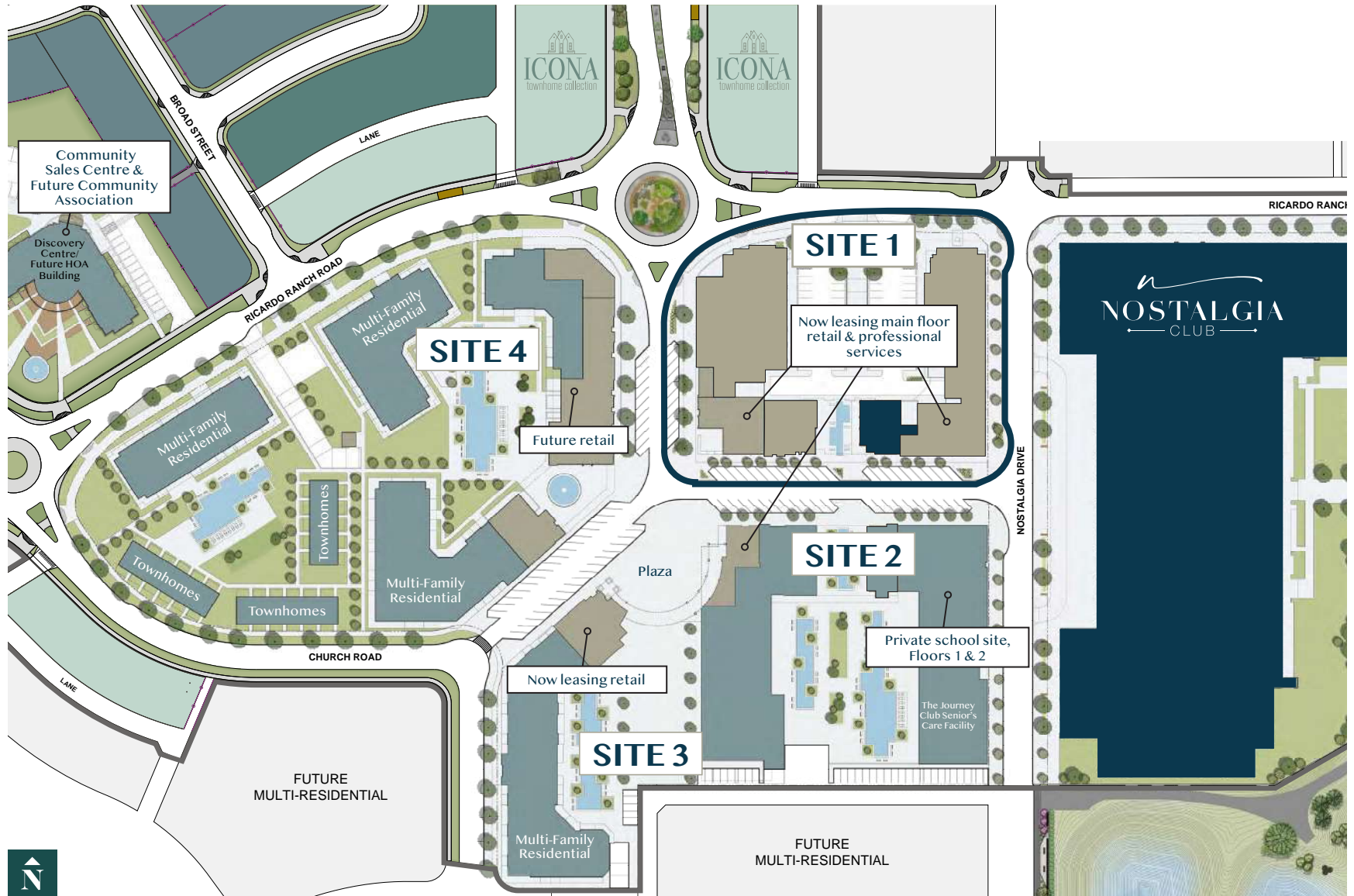

SITE 1 - RETAIL

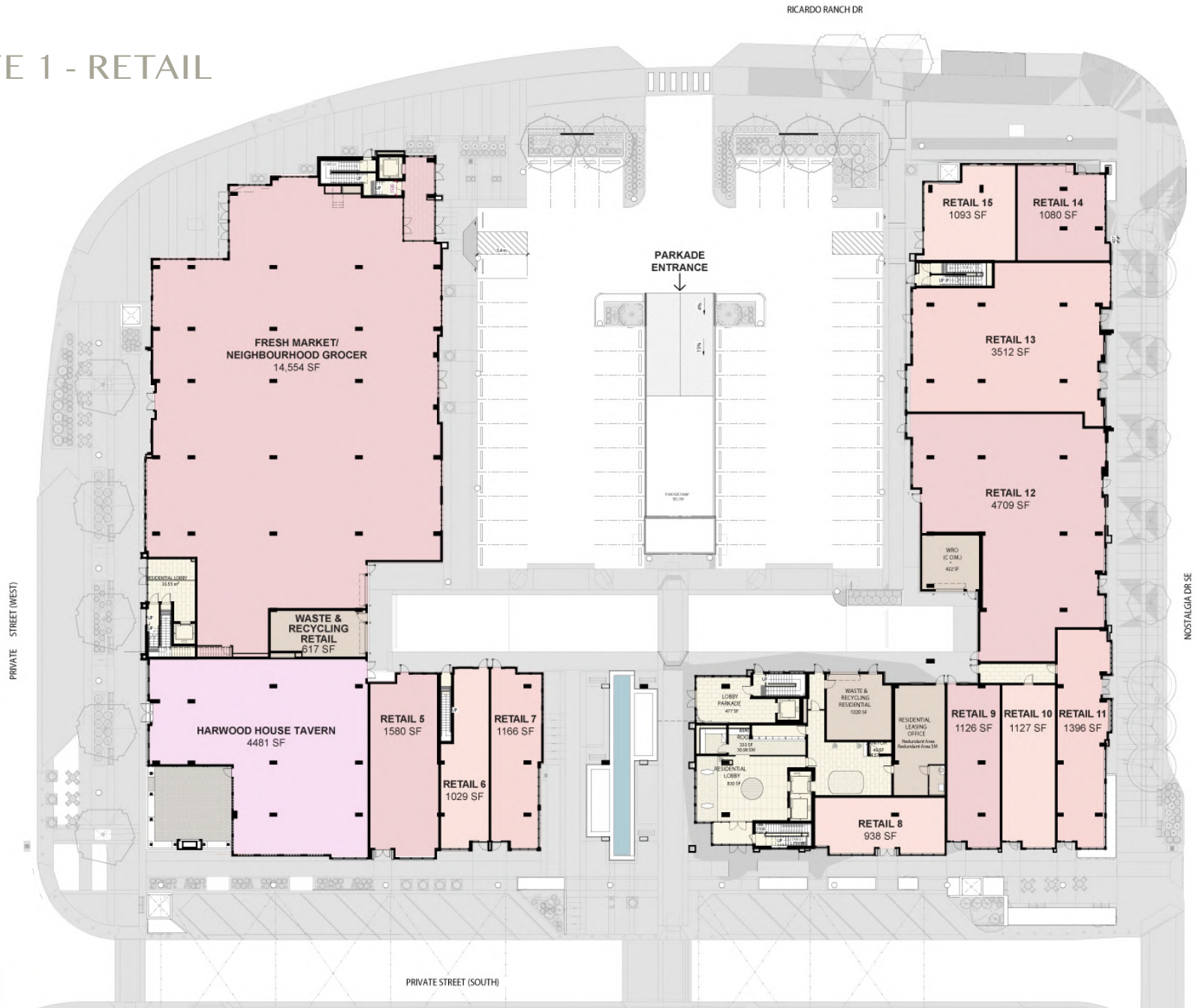

- Site 1 has over 50 retail surface parking stalls, plus street parking and assigned underground retail parking stalls.
- Availability for tenant fixturing Q4 2027.



NOSTALGIA MAIN STREET



Architectural renderings, for marketing purposes only. Subject to change.

SITE 1 - RENDERINGS

Southwest Corner / Looking South Toward Clock Tower and Plaza

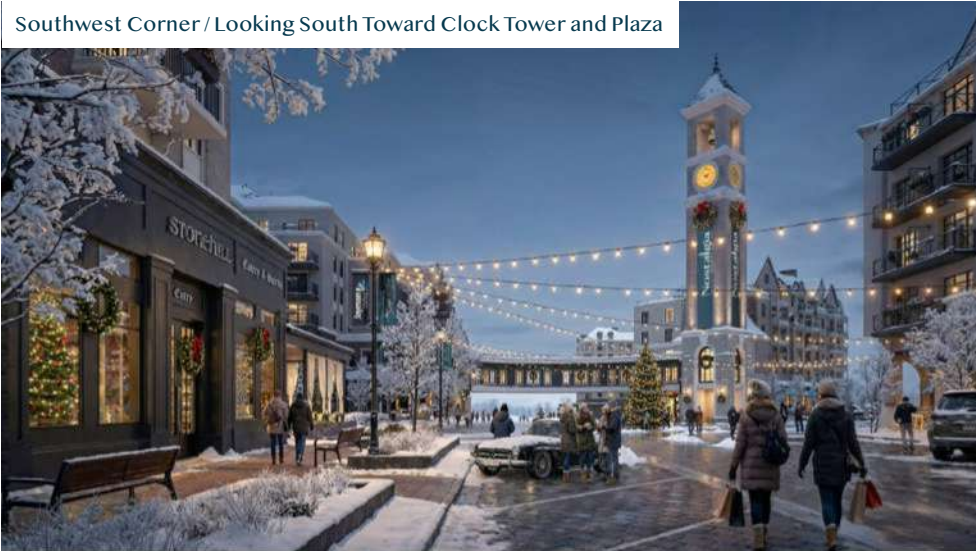

Southwest Corner / Looking North toward Building One

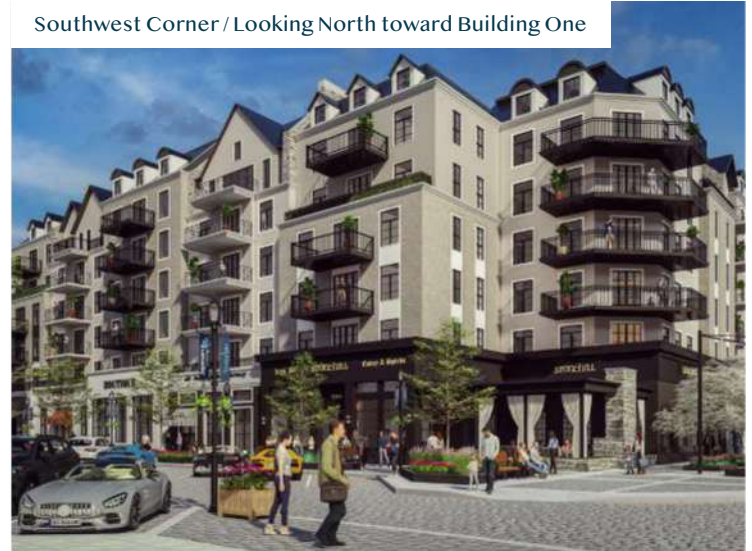

Building One / Looking South, Interior of Site One



Northwest Corner / Looking South toward Building One

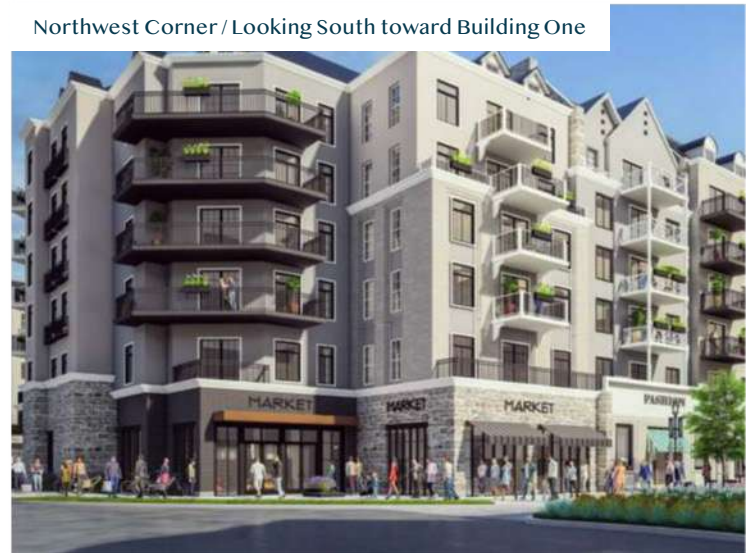

Architectural renderings, for marketing purposes only. Subject to change.

SITE 1 - HARWOOD HOUSE TAVERN



Architectural renderings, for marketing purposes only. Subject to change.



RETAIL INQUIRIES

Sean Flathers

*Telsec Property Corporation
Leasing Director*

403-203-3886

sflathers@telsec.ca

To learn more about Nostalgia Townlet, visit
NostalgiaTownlet.com



Subject to change.